

Chemical Escape Hood Xtreme



EXCEEDS ALL DEMANDS

10 YEARS SHELF TIME

XTREME QUALITY



UNIQUE PROTECTION EQUIPMENT

Chemical Escape Hood

ESCAPE HOOD XTREME

This escape hood is developed to exceed all demands for escape hoods and is highly recommended for concentrations above 1000 ppm. The hood's extremely low leakage, combined with the high class filter, gives significantly longer action time or protection for higher concentrations of dangerous substances. Shelf life for the filter is 10 years, which equals the best on the market!

One size.

Art. No. 7012P50022 Hood complete with combination filter A2B2E2K2P3 and carrying bag

Art. No. 7015000 7220 Replacement filter A2B2E2K2P3)



+ Xtremely low leakage! Test average in breathing zone is 0.06%, where 5% is the limit. In ocular zone it is 0.6%, where 20% is the limit!

+ High level filter withstands 5000 ppm. (Hood norm is 1000 ppm.)

+ Shelf life of the Xtreme hood filter is 10 years!

POINTS OF INTEREST

- Very easy to put on and off. No need for practice or education!
- No adjustments needed!
- Works better than full face mask for users with beard! (Covers the whole head.)
- Works with glasses!
- Protects face, ears and hair from chemicals and particles!
- The hood is made of a High Visibility material.
- The visibility is furthermore enhanced by reflective stripes.
- The seal around the neck is made of a special silicone which gives a very effective seal, but the hood is yet comfortable to wear.
- Twin exhaust valves ensure low respiratory resistance.
- Large sieve opening gives very good visibility.
- Can be used again, after inspection and filter change by TST.
- The hood is supplied with a practical and compact carrying bag with belt, which makes it easy to bring. It also has brackets for wall mount.
- CE approved as half mask according to EN140, with additional requirements from EN403 relevant for use as Escape Hood.

CARRYING BAG – IMPORTANT FOR SAFETY

The chemical escape hood comes with a soft carrying bag in a water resistant, strong and durable material. The format is very compact. It has a zipper for easy opening. In the rear, there is a pocket for filter date, name or a safety card. The bag can be worn on a belt, carried over the shoulder or round the waist. It also has brackets for wall mount. User instruction printed on bag and packed inside.



Filter information



HIGHER PROTECTION LEVEL

TST Sweden's escape hoods exceeds the requirements for escape hoods with great margin. Class 2 filter gives the user a higher level of protection, or longer action time. See the table below for the stipulated break-through times for filters, in concentrations as high as 5000 ppm. (Hood norm stipulates only 1000 ppm.)

// 58 MIN. PROTECTION H_2S 10000 PPM





On customer request, the TST Xtreme Hood has been tested for H_2S in higher concentrations.

Break-through time for 10,000 ppm was 58 minutes and for 20,000 ppm was 24 minutes. //

Stipulated break-through times for filters, acc. to EN 14387:2002

Filter type	Chemical substance	Concentration (ppm)	Time (minutes)
A2	Cyclohexane (C_6H_{12})	5000	35
B2	Chlorine (Cl_2)	5000	20
	Hydrogen sulfide (H_2S)	5000	40
	Hydrogen cyanide (HCN)	5000	25
E2	Sulfur dioxide (SO_2)	5000	20
K2	Ammonia (NH_3)	5000	40

Explanation filter coding

Filter type	Colour code	Protects from
A	Brown 	Organic gases w boilingpoint $>65^\circ C/150^\circ F$
B	Grey 	Inorganic gases and vapours
E	Yellow 	Sulphuric dioxide (SO_2)
K	Green 	Ammonia (NH_3)
P	White	Particles

EXAMPLE

A filter coded A2B2E2K2P3 protects the user from Cyclohexane for 35 min., Chlorine for 20 min., Hydrogen sulfide for 40 min., Hydrogen cyanide for 25 min., Sulphurous dioxide for 20 min. and Ammonia for 40 min. at a concentration of 5000 ppm in the air.



SHELF LIFE

The filter on the Escape Hood Extreme may be stored for 10 years in an unopened foil package. The packing date, and the "best before date" are stated on a label outside the foil packaging. When the date has expired, or the foil package has been opened, the hood must be inspected and the filter replaced. Contact an authorized TST Sweden Distributor for help and guidance.

EASY TO USE

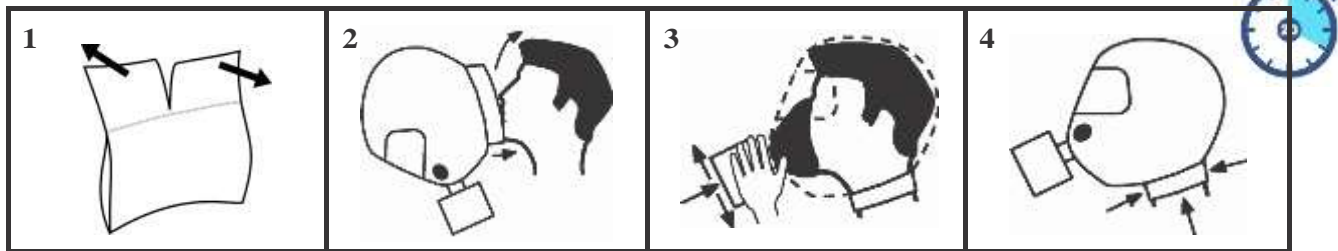

20 SECONDS TO DRESS



5000 PPM OR MORE

10 YEARS SHELF TIME

TECHNICAL SPECIFIKATIONS

Shelf life filter:	10 years in unopened foil package.
Filter type:	A2B2E2K2P3 Combination filter
Material:	67%polyester, 33% cotton.
Coating:	PVC
Seams:	Welded (no seams)
Inner mask:	Silicone rubber
Visor:	Anti fog treated
Size carrying bag:	Approx. 26x16x10 cm
Weight:	Approx. 640 g.
Washing instruction:	Not washable but can be wiped with a damp cloth.
Sizes:	One size fits all adults. (Not children)
Temp range:	-30 to +80
Break-through times filter:	CE EN14387:2002
Approved:	Approved as half mask according to EN140, with additional requirements from EN403 relevant for use as Escape Hood.

Certified according to ISO 9001:2008 and ISO 14001:2004



UNIQUE PROTECTION EQUIPMENT